

Student TAB Meeting

Minutes, January 27, 2017

605 Hodges Library, 3:30-4:45

Action Items

- Reeves – look into “have to fill out form and wait 24 hours” for Mutchler.
- Reeves – develop some alternative models for VolPrint charges.
- Reeves – talk with Dave Irvin (Facilities), Jonee Daniels (VolCard), and Jeff Maples (Bookstore) about point system for reverse vending machines.

Members

Voting members

Mark Alexander, **Ernest Bernard**, Tim Boruff (for Mark Alexander), **Andrew Capps** (alternate), Dakota Cauthen, **Bill Dunne**, Samson Girma, **Jennifer Gramling** (for Robert Hinde), Sherilyn Hammonds (Co-Chair), **Eric Hampton**, Robert Hinde, **David Mendez**, **Leigh Mutchler**, **Jacob Rogers**, **AJ Schroder**, Cory Tacosik, Brittany Wright (alternate) (**bold** indicates present)

Ex Officio members

Larry Jennings, **David Ratledge**, **Joel Reeves** (Co-Chair) (**bold** indicates present)

Welcome

- Happy New Year, and welcome back.

Updates

The Campus Market

- It is up and available; it's been advertised. No feedback so far.
- If OIT can help in any way, please let us know.

Canvas Survey

- In the interest of minimizing survey fatigue, we are going to add “Are you a Canvas user?” to the regular OIT spring survey. If yes, will get a few additional questions.
- **Mutchler**: Colleague states that OIT will no longer talk to her; she has to fill out a form and it takes at least 24 hours to respond. **Reeves**: This is news. **Jennings**: Has not heard about this. There is an option to fill out the online form.
- **Reeves**: This is not our model. Our model is, we answer the phone, we answer your questions.

Wireless Issue – Hess Hall – Larry Jennings

- Coverage issues in Hess Hall – first floor (not sure if meant basement, ground floor, or first floor). Pulled heat maps (see images at end of minutes).
- For the most part, we have coverage over pretty much all the space.
- Will send out information about what the colors mean.

- Was Hess part of the update three years ago? We used to run the access points down the hallway; now we've moved into the rooms, so there's more coverage in the rooms, slightly less coverage in the hallways.
- Working on a campus-wide heat map to show availability of outdoor wireless. We should have access from the Amphitheatre, across the bridge, Ayres Hall lawn and the Engineering quad.
- Survey still says "gaps on campus," but responses don't say where the gaps are.
- Dunne: When first encountered these heat maps, was during the HSS renovation. This is good information for the Classroom Upgrade Committee to have.

Lab Printing Cost Inquiry from SGA Committee on Environment and Sustainability

- Consider \$0.03 for duplex to minimize waste, instead of \$0.02 per side.
- Last update for our current model is \$0.028 per page, but not broken down by toner, paper, other costs. Model was that at \$0.02 per page, we have always underbilled this.
- There was a proposal to comp some printing, but by under-charging we are, in effect, comping some printing.

Table 1: VolPrint Financial Summary 2012-2016

Year	Print Expenses	Print Recoveries	Deficit (Surplus)
2012	216,292.54	(206,710.71)	9,581.83
2013	192,182.39	(168,994.28)	23,188.11
2014	197,291.85	(158,481.89)	38,809.96
2015	145,918.16	(150,276.75)	(4,358.59)
2016	162,531.90	(146,727.81)	15,804.09

- Potential Impact of \$0.03 Duplex
 - Approximately 6 million B&W print pages annually
 - Default setting is 'duplex'
 - 40% are single pages
 - 40% of print jobs are marked duplex already
 - Potential additional cost of \$12,000-\$36,000 annually above existing deficit
- **Dunne:** Why not \$0.03 per page for everything? It's kind of like a gas tax; there should be declining revenue because people will move from single- to duplex-, but for the first year, it might help balance the loss.
- **Bernard:** How does charging more to encourage duplex printing cause additional costs?
Mendez: Is this \$0.03 more or less? **Reeves:** Currently \$0.02 per side, so \$0.04 per duplexed page. **Dunne:** suggests 0.03 for everything. **Reeves:** We could develop that model. Our current charge of \$0.02 per side is less than most other campuses.
- **Mendez:** E&S wants to reduce paper waste. We don't want increased cost; why not leave duplex as it stands and increase single-page print cost.

- **Hampton:** Cost is 0.028 per page? **Reeves:** Model is to partially subsidize. Not sure how we ended up with a surplus in 2015. **Alexander:** Could that have come from purchasing supplies the previous fiscal year? **Reeves:** Possibly.

Lynda.com

- Contract up in October, 2017
- Vendor has indicated a new agreement will have a 35-40% increase; this is common across Higher Education (was \$98,000 per year for three years). They've been bought by Microsoft.
- Looking at other options
 - Drop Service (Knox County Library provides access – not sure how that works; Reeves plans to contact them and ask)
 - Bid again (Atomic Learning bid last time, but much smaller catalog)

FY 18 College/Department Award Process

Table 2: FY 18 College / Department Tech Fee Award Process

Time frame	Process step
February 2017	Call for Tech Fee requests
April 3, 2017	Deadline for submissions
April 28, 2017	TAB review/approval
Early May 2017	Award notifications to colleges/departments

- Every dean and associate / assistant dean gets the letter.
- This committee prioritizes the requests and awards.

New Business

Reverse Vending Machines – Jacob Rogers

- Connor Clarke on the Environment & Sustainability committee proposed, and the committee has approved, installing “reverse vending machines.” Sponsors will pay for it. There will be two machines (Student Union and Hodges), probably by the end of the semester, but not certain.
- Glorified recycle bin – you put the can or bottle in the machine and it's crushed and kept.
- Need an incentive – looking for the feasibility of using card swipes to put points on students' VolCards that can be spent at the VolShop. This would also increase VolShop revenue.
- Card readers seem pretty straightforward, but point system is probably more difficult to implement.
- Reeves will talk with Dave Irvin (Facilities), Jonee Daniels (VolCard), and Jeff Maples (Bookstore). This isn't really a Technology Fee project, but OIT could be involved.

Committee Meeting Dates (Hodges 605 except October)

- September 23, 2016
- October 21, 2016 – Hodges Library Conference Room 150
- November 18, 2016
- January 27, 2017

- February 24, 2017
- March 24, 2017
- April 28, 2017

Wrap-up

- Please contact Reeves with any items for next meeting.

Meeting Adjourned

Figure 1: Hess Hall Basement "Heat Map" (Wireless signal strength) (Blue: -75 to -66 dBm, Green: -65 to -56 dBm, Orange: -55 to -46 dBm, Red: -45 to -36 dBm)

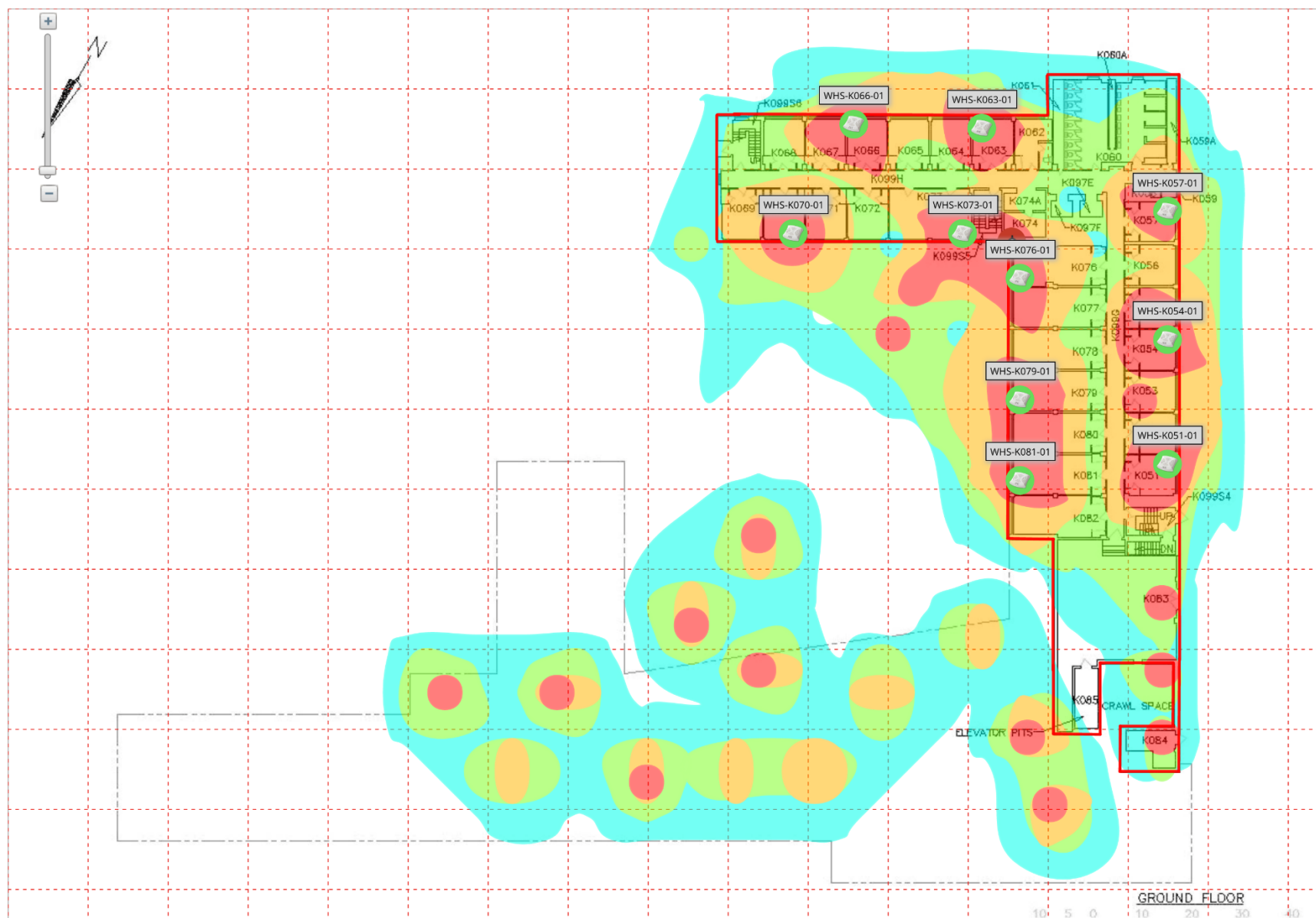

Figure 2: Hess Hall Ground Floor "Heat Map" (Wireless signal strength) (Blue: -75 to -66 dBm, Green: -65 to -56 dBm, Orange: -55 to -46 dBm, Red: -45 to -36 dBm)

